

327(-HDS)

14,5 mm

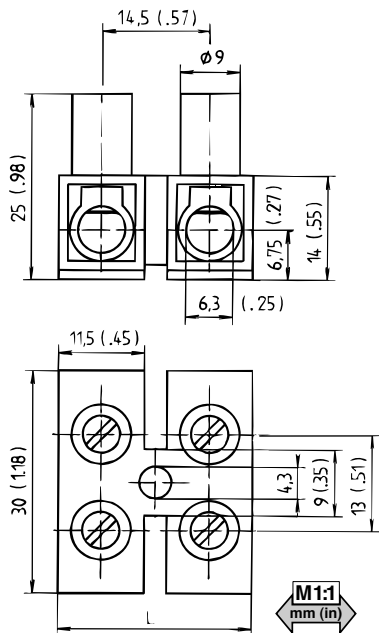

Standard Version



Length (L):

Pole	mm	in	4	58,00	2,28	9	130,50	5,14
1	14,50	0,57	5	72,50	2,85	10	145,00	5,71
2	29,00	1,14	6	87,00	3,43	11	159,50	6,28
3	43,50	1,71	7	101,50	4,00	12	171,00	6,73
			8	116,00	4,57			

Order Table

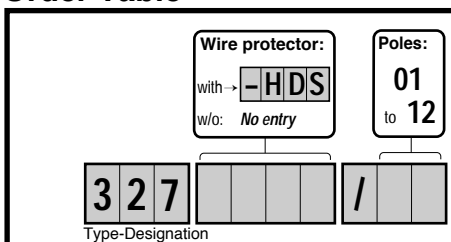

327-FU(-HDS)

14,5 mm



Version with raised base

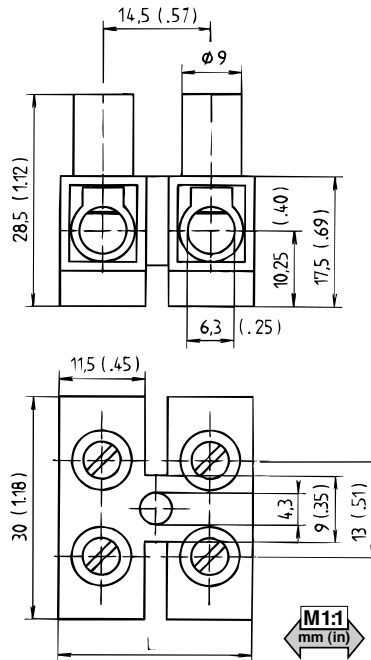

Length (L):

Pole	mm	in	4	58,00	2,28	9	130,50	5,14
1	14,50	0,57	5	72,50	2,85	10	145,00	5,71
2	29,00	1,14	6	87,00	3,43	11	159,50	6,28
3	43,50	1,71	7	101,50	4,00	12	171,00	6,73
			8	116,00	4,57			

Order Table

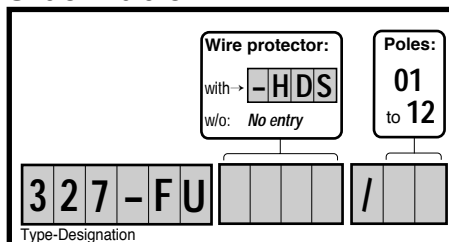

Technical Details

Center-to-Center Spacing:

14,5 mm / 0.57 in

Rated Connecting Capacity: to EN 60 998
16 mm² / 5 AWG

Terminal Range:

With or w/o wire protector up to 16 mm² solid wire
with or w/o wire protector up to 10 mm² stranded wire

Rated Insulation Voltage: 750 V to EN 60 998

Rated Voltage: 500 V

to DIN VDE 0110, pollution degree 3 / III

Creepage and clearance distance:

Type 327(-HDS): > 9,5 mm = 600 V, pollution degree 3

Type 327-FU(-HDS): > 12,5 mm = 600 V, pollution degree 4

Rated Current: 82 A

to DIN VDE 0289, Part 4, Table 6, Column 6

Test Current: 76 A to EN 60 998

Stripping Length: 9 mm / 0.35 in

Depending on application, equipment safety regulations must be observed.

International Approvals



327(-HDS)

additional:



Data see page 72.

Material

Screw: M 5;

⌀ max. 2 Nm / 16 lb-in

Further details see

General Description page 10.

Description

The screw M 5, the large terminal space and the creepage distance of more than 9 mm between metal part and ground allows larger cross-sections, voltages and currents.

The raised base of the FU-type extends the creepage distance to the ground which allows 600 V in accordance with UL and CSA regulations without an additional insulating base.

Options

⊗ Marking strips and labels, see page 29.